

V-BAND H-PLANE 90° BEND

Model Name : **NRD60BD101**

DATE: SEP/06/2002

Serial Number : **B90H020827-01**

Specifications

Parameters	Specifications
Frequency Range	55GHz ~ 65GHz
Loss	0.5dB typical
VSWR	1.07:1
IN/OUT Port	WR-15/4-40 Tap/Hole
Size(LxWxH)[mm]	30x30x20

Dimensions

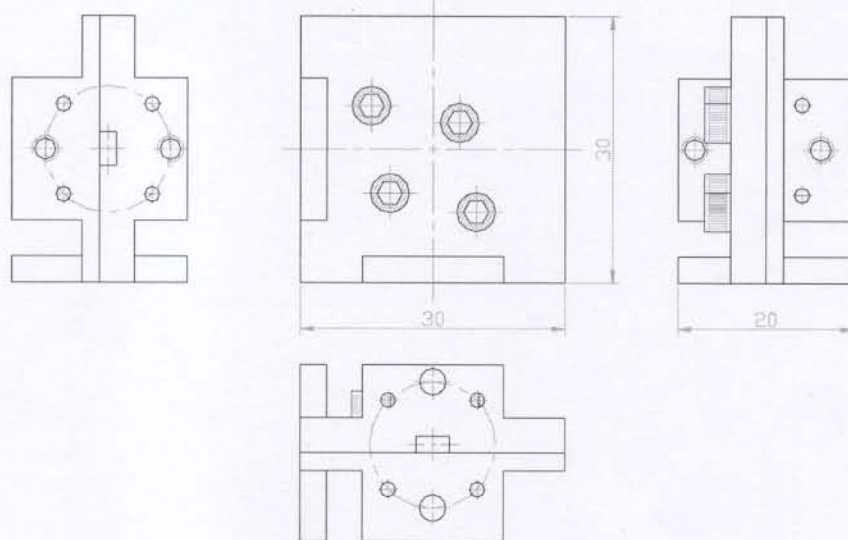

Descriptions

1. The port is compatible with WR-15 standard V-band rectangular waveguide. One port fit to 4-40 UNC bolt and the other reserved just hole of $\phi 3$.
2. All Dimensions of above drawing are in millimeters.

37397A

MODEL: *NRD60BD101* DATE: 09/09/2002 15:13 Page 1
 DEVICE ID: *B90H020027-01* OPERATOR: *ys kim*

START: 55.000000 GHz GATE START: - ERROR CORR: 12-TERM
 STOP: 65.000000 GHz GATE STOP: - AVERAGING: 1 PT
 STEP: 0.006250 GHz GATE: - IF BNDWDTH: 1 KHz
 WINDOW: -

PARAMETER: <i>Bend - V</i>	-----CH1-----	-----CH3-----
NORMALIZATION:	-S11-	-S21-
REFERENCE PLANE:	OFF	OFF
SMOOTHING:	0.0000 mm	0.0000 mm
DELAY APERTURE:	0.0 PERCENT	0.0 PERCENT
	-	-

CH1: S11 FWD REFL
 LOG MAGNITUDE
 REF=0.000 dB
 10.000 dB/DIV

CH3: S21 FWD TRANS
 LOG MAGNITUDE
 REF=0.000 dB
 10.000 dB/DIV

CH 3 - S21
 REFERENCE PLANE
 0.0000 mm

MARKER 2
 60.000000 GHz
 -0.541 dB

MARKER TO MAX
 MARKER TO MIN

1 59.000000 GHz
 -0.567 dB
 3 61.000000 GHz
 -0.627 dB

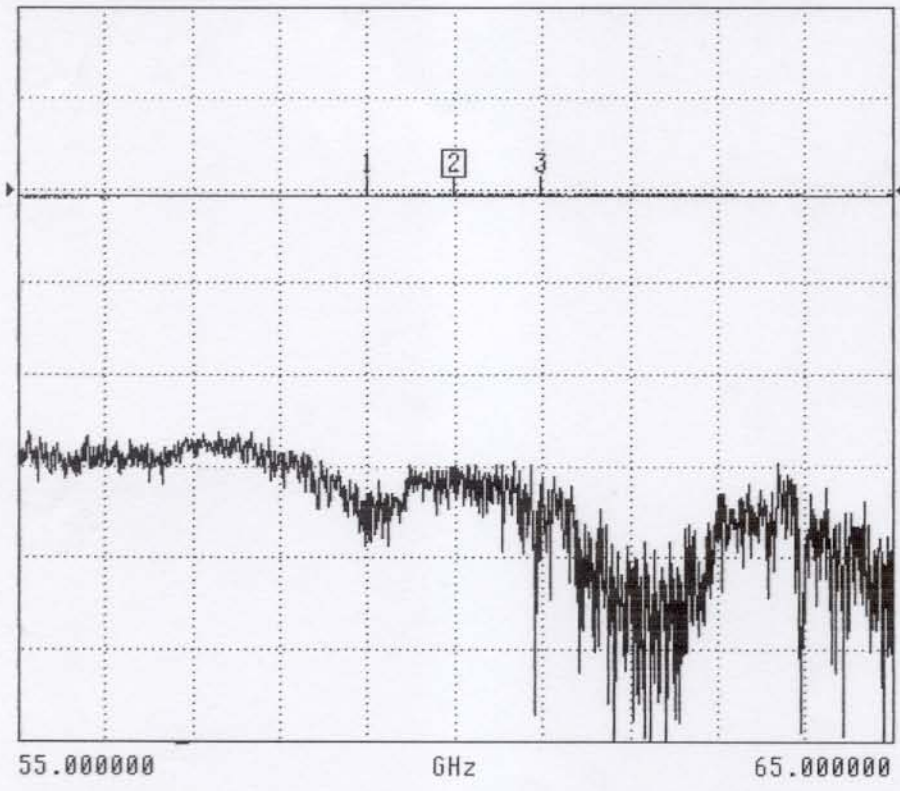

MARKER READOUT
 FUNCTIONS