

60GHz BANDPASS FILTER

Model Name : **NRD60FT101**

DATE: SEP/06/2002

Serial Number : **FC020902-04**

Specifications

| Parameters | Specifications |
|------------------|-----------------------|
| Center frequency | 59.850GHz |
| Pass Band | 59.550GHz ~ 60.150GHz |
| Band Width | 600MHz |
| Insertion Loss | 3.7dB max |
| VSWR | 1.28:1 |
| Rejection | 58dBc@1GHz |
| IN/OUT Port | WR-15 |
| Size(LxWxH)[mm] | 36x19x19 |

Dimensions

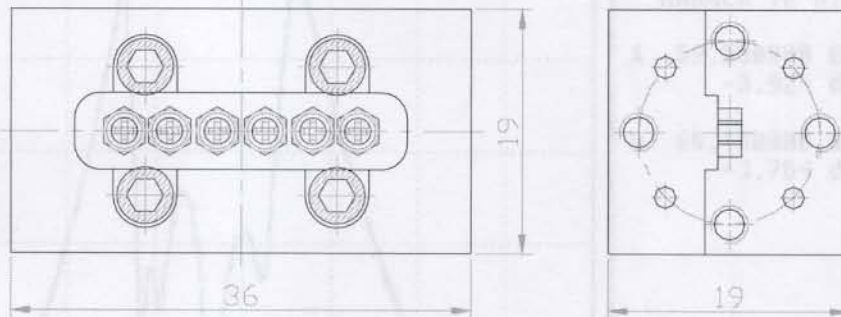

Descriptions

1. The port is compatible with WR-15 standard V-band rectangular waveguide.
2. Do not turn the tuning screw placed in center pocket voluntarily. The filter tuned precisely for maximum performance already.
3. All Dimensions of above drawing are in millimeters.

4

37397A

MODEL: *NRD 60 HT101*
 DEVICE ID: *HC020902-04*

DATE: 09/09/2002 13:11

Page 1

OPERATOR: *YS KIM*

START: 57.000000 GHz
 STOP: 62.000000 GHz
 STEP: 0.003125 GHz

GATE START: -
 GATE STOP: -
 GATE: -
 WINDOW: -

ERROR CORR: 12-TERM
 AVERAGING: 1 PT
 IF BNDWTH: 10 Hz

PARAMETER:
 NORMALIZATION:
 REFERENCE PLANE:
 SMOOTHING:
 DELAY APERTURE:

-----CH1-----
 -S11-
 OFF
 0.0000 mm
 0.0 PERCENT

-----CH3-----
 -S21-
 OFF
 0.0000 mm
 0.0 PERCENT

CH1: S11 FWD REFL
 LOG MAGNITUDE
 REF=0.000 dB
 5.000 dB/DIV

CH3: S21 FWD TRANS
 LOG MAGNITUDE
 REF=0.000 dB
 10.000 dB/DIV

CH 3 - S21
 REFERENCE PLANE
 0.0000 mm

MARKER 2
 59.850000 GHz
 -3.209 dB

MARKER TO MAX
 MARKER TO MIN

1 59.550000 GHz
 -3.924 dB
 3 60.150000 GHz
 -3.784 dB

MARKER READOUT
 FUNCTIONS

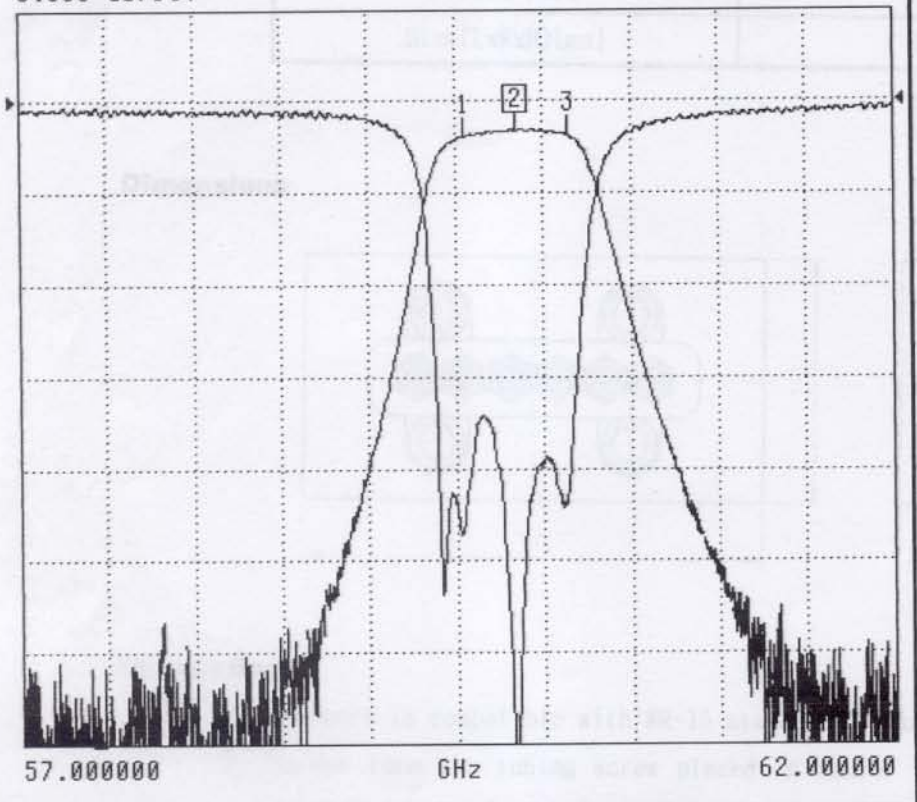

Dimensions of above drawing are in millimeters.