

60GHz RECEIVER

Model Name : **NRD60RX001**

DATE: SEP/06/2002

Serial Number : **RA020906-03**

Specifications

Parameters	Specifications
RF Frequency Range	58GHz ~ 62GHz
Conversion Gain	47dB
Dynamic Range	-20dBm to -60dBm
Noise Figure	6.0dB max
RF Input VSWR	1.5:1
Base band Output VSWR	2.0:1
RF Port	WR-15
Signal Output Port	SMA(f)
Bias	+5V/140mA
Size(LxWxH)[mm]	80x110x26

-30dBm

Dimensions

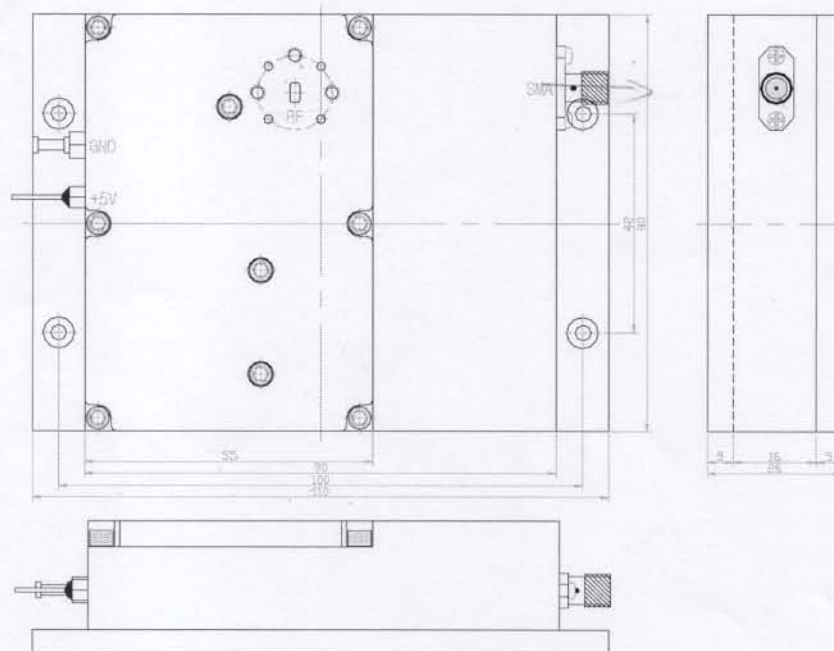

Descriptions

1. DC Bias should be connected ground(GND) first, and then +5V next.
2. RF port maximum power must be permitted below -15dBm.
3. SMA female port is matched at 50Ω impedance.
4. RF port is compatible with WR-15 standard V-band rectangular waveguide.
5. All Dimensions are in millimeters.

37397A

MODEL: *NRD 60 Rx 001*
DEVICE ID: *RA020906-03*

DATE: 09/09/2002 15:06
OPERATOR: *Y.S. Kim*

Page 1

START: 58.000000 GHz
STOP: 62.000000 GHz
STEP: 0.006250 GHz

GATE START: -
GATE STOP: -
GATE: -
WINDOW: -

ERROR CORR: 12-TERM
AVERAGING: 1 PT
IF BNDWIDTH: 100 Hz

PARAMETER: *Rn port* -----CH1-----
NORMALIZATION: -S11-
REFERENCE PLANE: 0.0000 mm OFF
SMOOTHING: 0.0 PERCENT
DELAY APERTURE: -

S11 FORWARD REFLECTION

LOG MAGNITUDE ▶REF=0.000 dB 10.000 dB/DIV

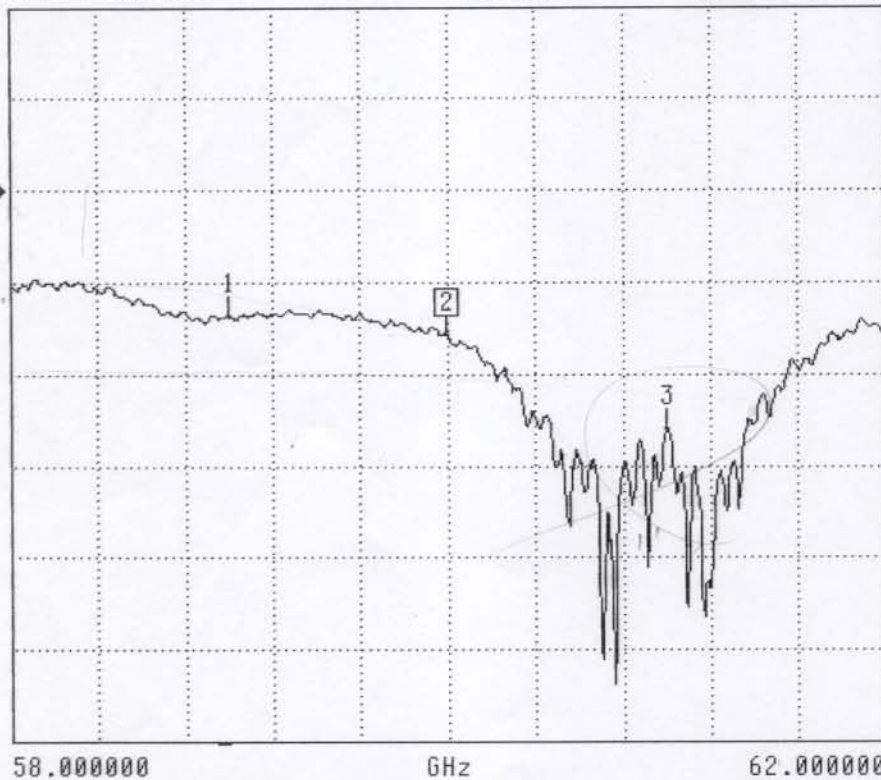

CH 1 - S11
REFERENCE PLANE
0.0000 mm

▶MARKER 2
60.000000 GHz
-15.760 dB

MARKER TO MAX
MARKER TO MIN

- 1 59.000000 GHz
-13.707 dB
- 3 61.000000 GHz
-25.929 dB

MARKER READOUT
FUNCTIONS

37397A

MODEL: *NRD60 RX001*
DEVICE ID: *RA020906-03*

DATE: 09/09/2002 15:44
OPERATOR: *ORRYU*

Page 1

START: 0.040000 GHz
STOP: 3.003100 GHz
STEP: 0.006225 GHz

GATE START: -
GATE STOP: -
GATE: -
WINDOW: -

ERROR CORR: 12-TERM
AVERAGING: 1 PT
IF BNDWDTH: 1 KHz

PARAMETER: *Base band Output VSWR* -----CH1-----
NORMALIZATION: -S11-
REFERENCE PLANE: 0.0000 mm
SMOOTHING: 0.0 PERCENT
DELAY APERTURE: -

S11 FORWARD REFLECTION

LOG MAGNITUDE REF=0.000 dB 10.000 dB/DIV



CH 1 - S11
REFERENCE PLANE
0.0000 mm

▶ MARKER 3
0.600250 GHz
-22.915 dB

MARKER TO MAX
MARKER TO MIN

1 0.102250 GHz
-10.660 dB
2 0.301450 GHz
-10.003 dB

MARKER READOUT
FUNCTIONS