

## SM Series

## Vernier Micrometers

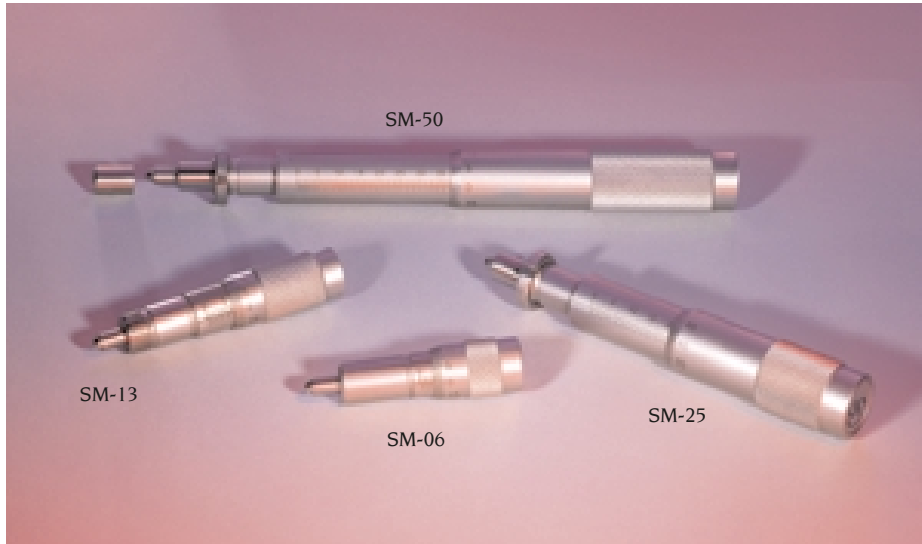

**SM Series Metric Micrometers** offer high-resolution and smooth movement for the most demanding requirements. Our standard drives for most stages, SM Series micrometers are Newport's most popular manual actuators and are available in travel ranges from 6–50 mm.

SM Series metric micrometers have 0.5 mm pitch (50.8 TPI) threads and read directly in units of 10  $\mu\text{m}$ , with vernier reading of 1  $\mu\text{m}$ . Left-hand threaded versions are preferred when the micrometer is mounted on the moving platform of a stage so that turning the micrometer moves the stage in the direction of the micrometer travel.

## Specifications

Graduations ( $\mu\text{m}$ )	10
Vernier Graduations* ( $\mu\text{m}$ )	1
Sensitivity ( $\mu\text{m}$ )	1

\* SM-06 does not have a vernier scale.

## Ordering Information

Model	Travel (mm)	Load Capacity [lb (N)]	Price
SM-06	6	9 (40)	\$72
SM-13	13	9 (40)	\$59
SM-13LH	13	9 (40)	\$59
SM-25	25	23 (100)	\$89
SM-50	50	23 (100)	\$175

Left-hand threaded versions contain "LH" in the Model number.

## Key Features

- 1  $\mu\text{m}$  sensitivity
- 6–50 mm travel
- Steel construction

Compatible with these stages\*:

- 461/462 Series
- 561/562 Series
- 423/433/443 Series
- 426/436 Series
- 460P Series
- 460A Series
- 401/406 Series
- RS Series
- GON Series

\*in addition to many of our modular optical mounts.



Use a left-hand threaded micrometer for intuitive motion when the micrometer mount is mounted to the moving platform.

MANUAL LINEAR  
TRANSLATION STAGES

MOTORIZED LINEAR  
TRANSLATION STAGES

MANUAL ROTATION  
STAGES

MOTORIZED ROTATION  
STAGES

FIBER POSITIONERS

ACTUATORS

CONTROLLERS &  
AMPLIFIERS

TECHNICAL REFERENCE

**Model SM-06**

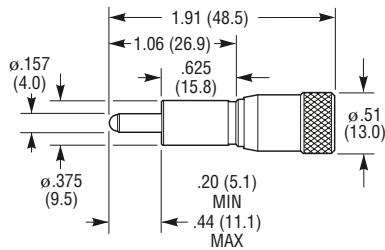

**Models SM-13, SM-13LH, SM-25, SM-50**

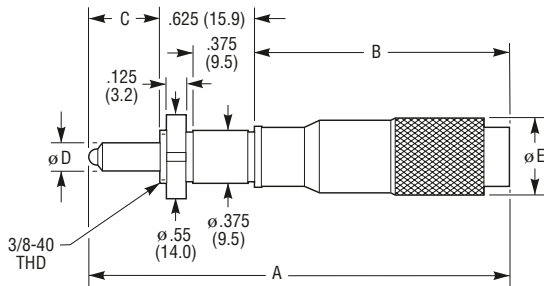

Dimension [in. (mm)]

Model	A	B		C		D	E
		Min	Max	Min	Max		
SM-13, SM-13LH	2.36 (59.9)	1.18 (30)	1.69 (43)	0.05 (1.3)	0.56 (14.2)	0.157 (4.0)	0.51 (12.9)
SM-25	3.83 (97.3)	1.98 (50.2)	2.96 (75.2)	0.26 (6.6)	1.23 (31.2)	0.275 (7.0)	0.625 (15.9)
SM-50	5.70 (144.8)	2.95 (74.9)	4.92 (125)	0.157 (4.0)	2.13 (54.1)	0.275 (7.0)	0.625 (15.9)

See our website for CAD files.